



**NAAT Batt 2025**  
**Ratel Consulting LLC**  
**Strategies For Innovation**

# DISCLAIMER

These materials have been prepared in connection with your consideration of a potential business transaction with Ratel Consulting LLC (The “Company”). These materials are confidential and are intended solely for the individual or entity to whom such materials are sent directly by the Company or its advisors, may not be used or relied upon by any other person or for any purpose, and may not be reproduced, disseminated, quoted or referred to, in whole or in part, without the prior written consent of the Company. Neither the Company nor any of its representatives (i) makes any express or implied representation or warranty as to the accuracy or completeness of the information contained in these materials, or (ii) shall have any liability resulting from your use of these materials. These materials are not intended to provide the sole basis for evaluating any transaction or other matter. These materials do not constitute an offer or solicitation to sell or purchase any securities.

These materials contain certain estimates, projections and forward-looking statements. The estimates, projections and forward-looking statements contained herein may or may not be realized, and differences between estimated results and those actually realized may be material. Such estimates, projections and forward-looking statements reflect various assumptions of management concerning the future performance of the Company, and are subject to significant business, economic, technology, and competitive uncertainties and contingencies, many of which are beyond the control of the Company. Accordingly, there can be no assurance that such estimates, projections or forward-looking statements will be realized. No representations or warranties are made as to the accuracy or reasonableness of such assumptions, or the projections or forward-looking statements based thereon. Only those representations and warranties that are made in a definitive written agreement relating to a transaction concerning the Company, when and if executed, and subject to any limitations and restrictions as may be specified in such definitive agreement, shall have any legal effect. Each recipient should make an independent assessment of the merits of pursuing any transaction and should consult its own professional advisors. Except as otherwise noted, the materials speak as of the date of this presentation. The delivery of these materials should not create any implication that there has been no change in the business and affairs of the Company since such date. Neither the Company nor any of its affiliates or representatives undertakes any obligation to update any of the information contained herein. By accepting a copy of this document, each recipient agrees for itself and each of its related bodies corporate and their respective directors, officers, employees, agents and advisors to be bound by these terms.

---

## INTRODUCTION

- Founded in 2017 and Located in Kendall Square, Cambridge, MA
- Growth advisory built on market intelligence for the energy storage value chain
- 100+ projects delivered across the battery value chain
- Engagements in adjacent industries & with early-stage technology affords unique insights and holistic approach to growth
- Global network of technical experts in industry & academia, OEM senior management, media, & finance professionals



# INDUSTRY PRESENCE

We Are Inside the Platforms and Institutions To Influence High Level Stakeholders



Four-time author of the most read report in the world covering the battery industry



Frequently quoted and featured in leading industry publications and presentations

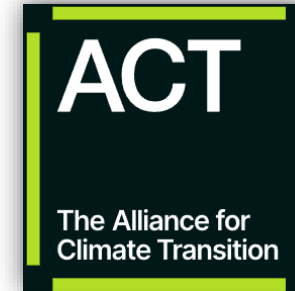

Leadership in industry groups with global reach

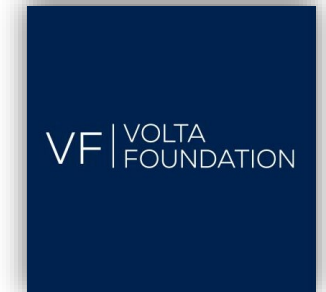

# SERVICES BY PHASE

Catalyzing Growth At Every Point



Actionable Intelligence

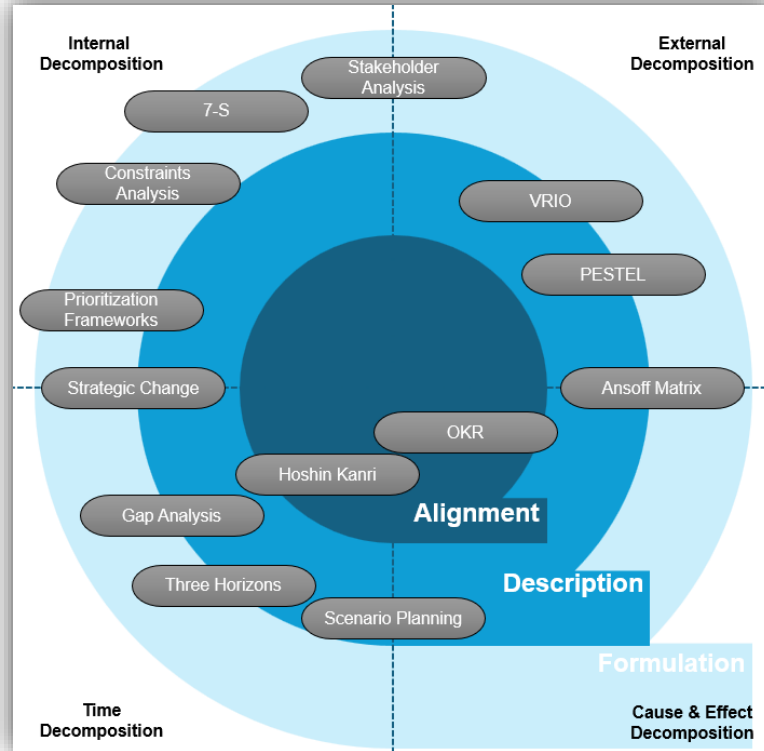

Holistic Strategy

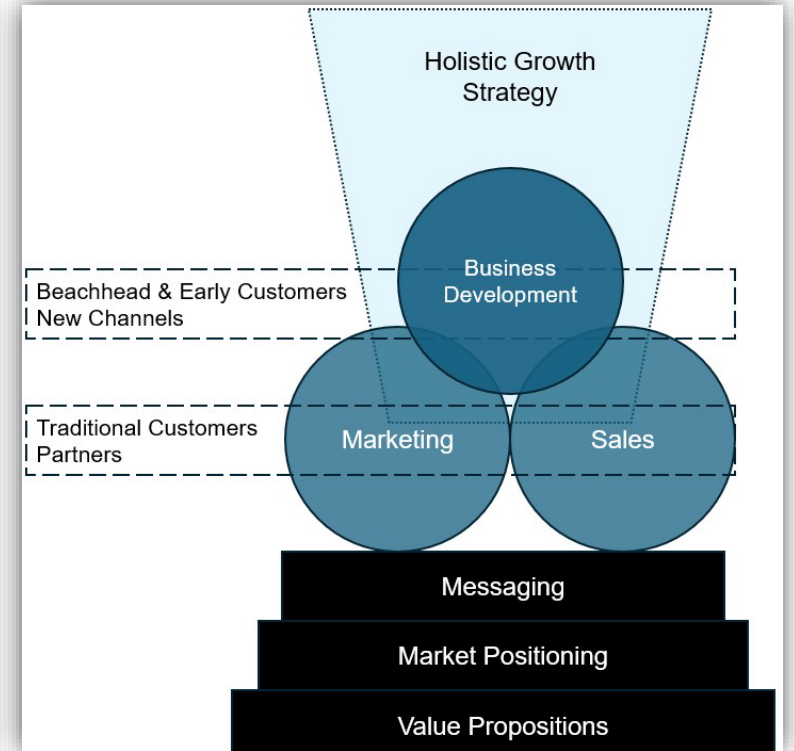

Practicable Execution

# PROCESS ENVIRONMENT MAPPING

## Inside View of Leading-Edge Cell Manufacturing Facilities

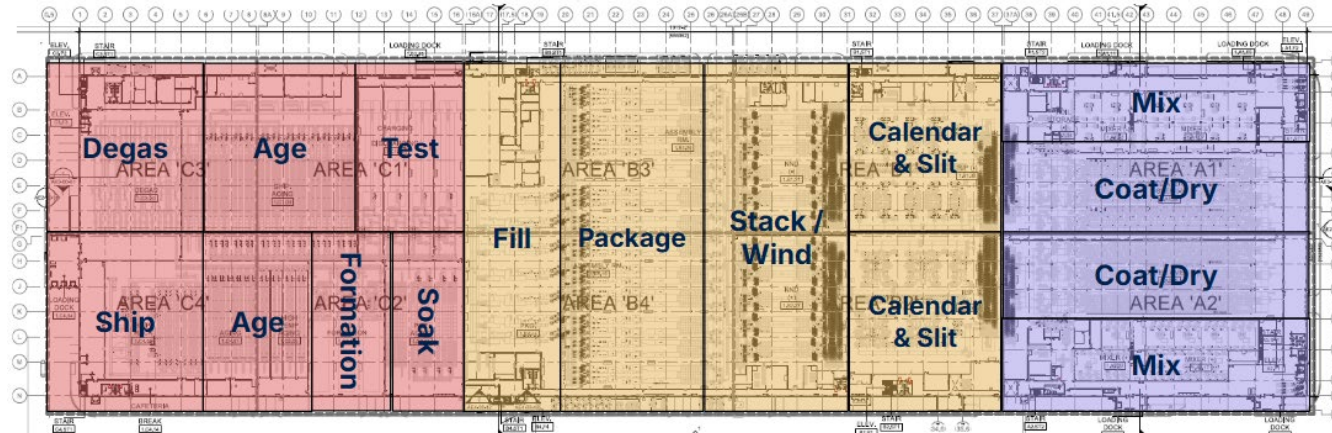
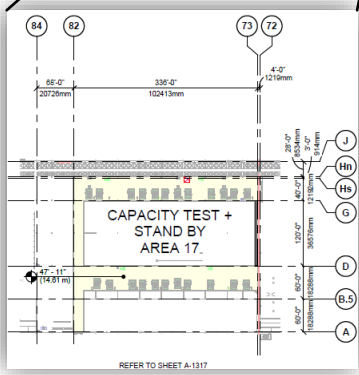
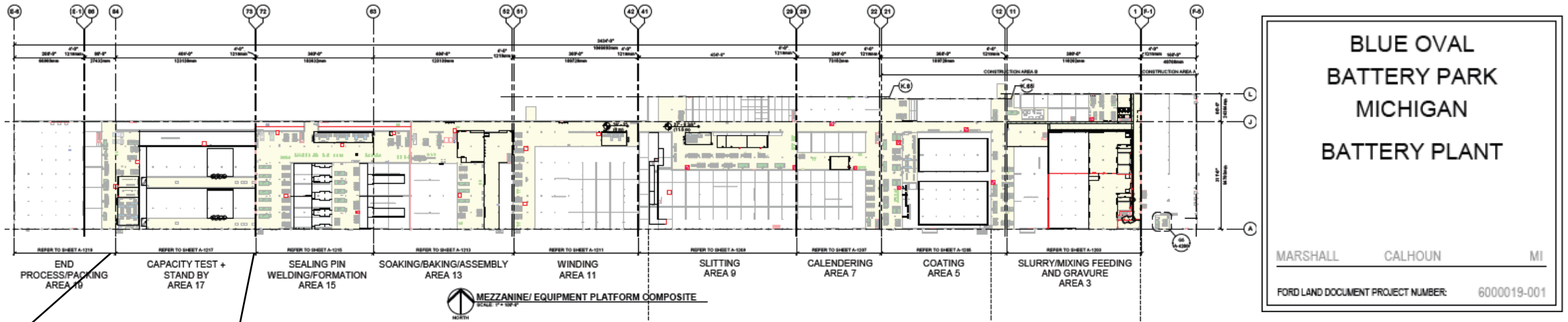

**LG Energy Solution**  
Michigan, Inc.

**LGES MI2 - Holland Expansion**

1 LG WAY  
HOLLAND, MI 49423

# PRODUCTION MAPPING

Visualizing Business Relationships In a Real Production Environment

C  
u  
s  
t  
o  
m  
e  
r  
s

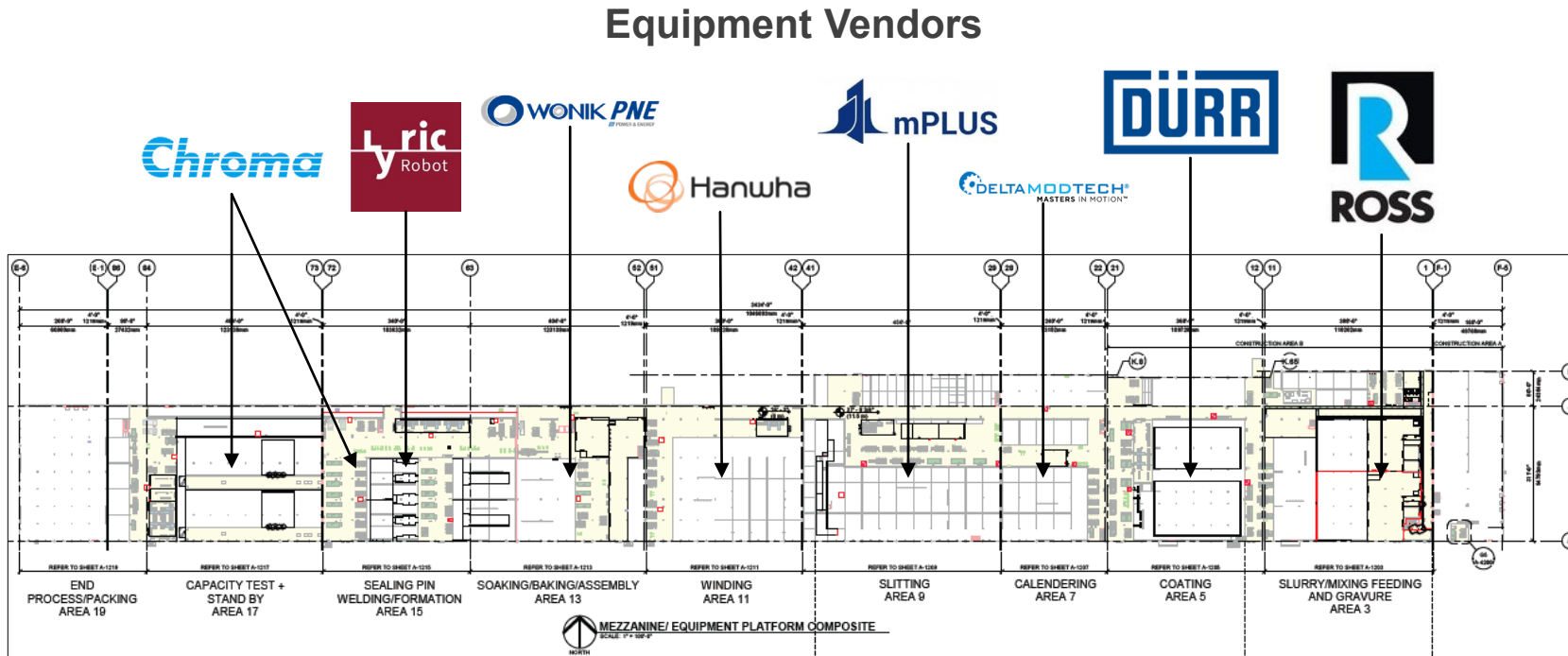

S  
u  
p  
p  
l  
i  
e  
r  
s

EcoPro  
posco  
enchem  
TARGRAY  
CELGARD

VOLTAIQ

PDF/SOLUTIONS™

SIEMENS



Other Vendors

# DYNAMIC APPLICATION MODELING

## Utilizing EV OEM Tools To Build a Business Case

- EV OEMs now can validate nearly any battery and powertrain technology
- EV OEMs may not be your direct customer but have enormous influence over
- Ability to calculate cost difference for equivalent range on a specific model or platform is more important than any system or performance improvement metric
- Simulation modeling using standard EV range test protocols (EPA, WLTP, WLTC, CLTC) provides the common standard for comparison

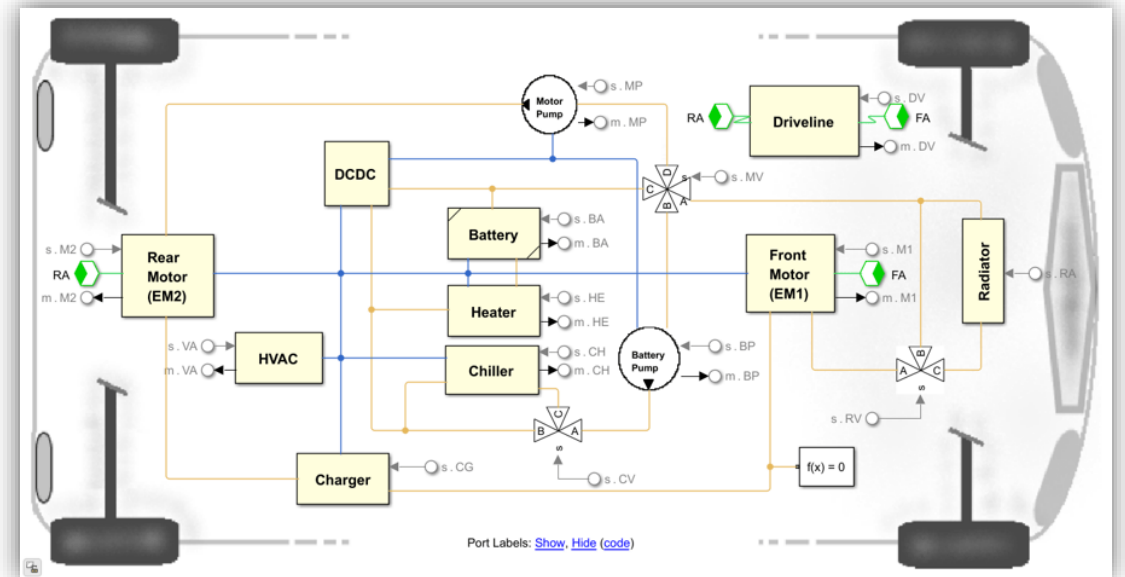
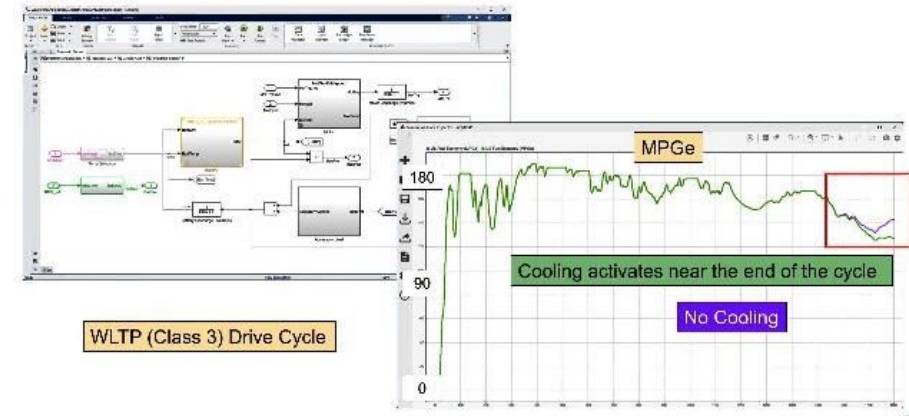



# DYNAMIC APPLICATION MODELING + TECHNO-ECON ANALYSIS

Comparative P&L Analysis for Decision Makers With P&L Responsibility

- The decision makers you need to convince understand dollars and cents above all else
- There is a need to elucidate unit level and responsibility level financial impact
- There is also a need to understand the holistic financial impact

Single 50 kWh EV Pack BoM			EV Fleet Pack BoM @ 500K Units		
Cost	Current	Proposed	Cost	Current	Proposed
CAM	\$1,400	\$1,250	CAM	\$700M	\$625M
Other Material	\$1,500	\$1,500	Other Material	\$750M	\$750M
Manufacturing	\$1,000	\$1,000	Manufacturing	\$500M	\$500M
Pack	\$1,850	\$1,650	Pack	\$925M	\$825M
<b>Total</b>	<b>\$5,750</b>	<b>\$5,400</b>	<b>Total</b>	<b>\$2,875M</b>	<b>\$2,700M</b>

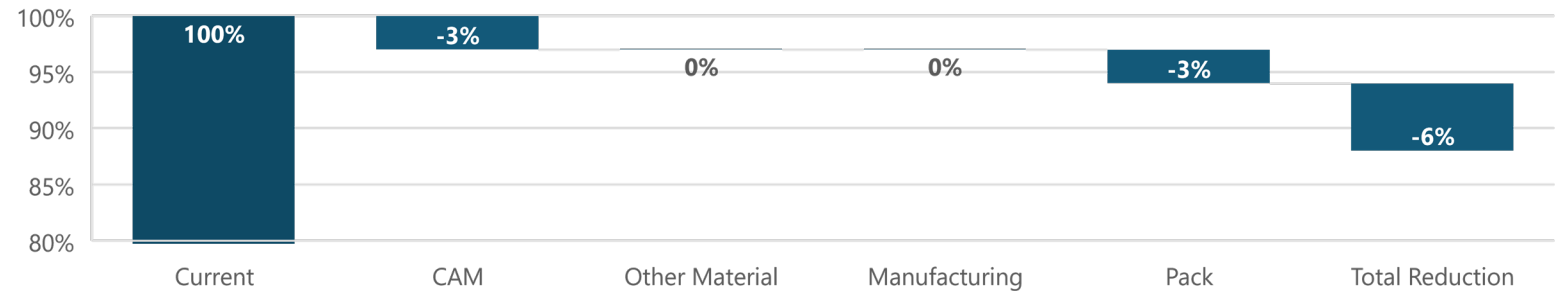

# SUMMARY

## Adding Value By Using the Same Data Foundation

- Traceability and ESG labeling may be a requirement for both public and private companies
- ISO 14040, SAE J3327, and other related compliance standards
- Bundling cost centers with value added services creates a more attractive option while reducing cost and complexity

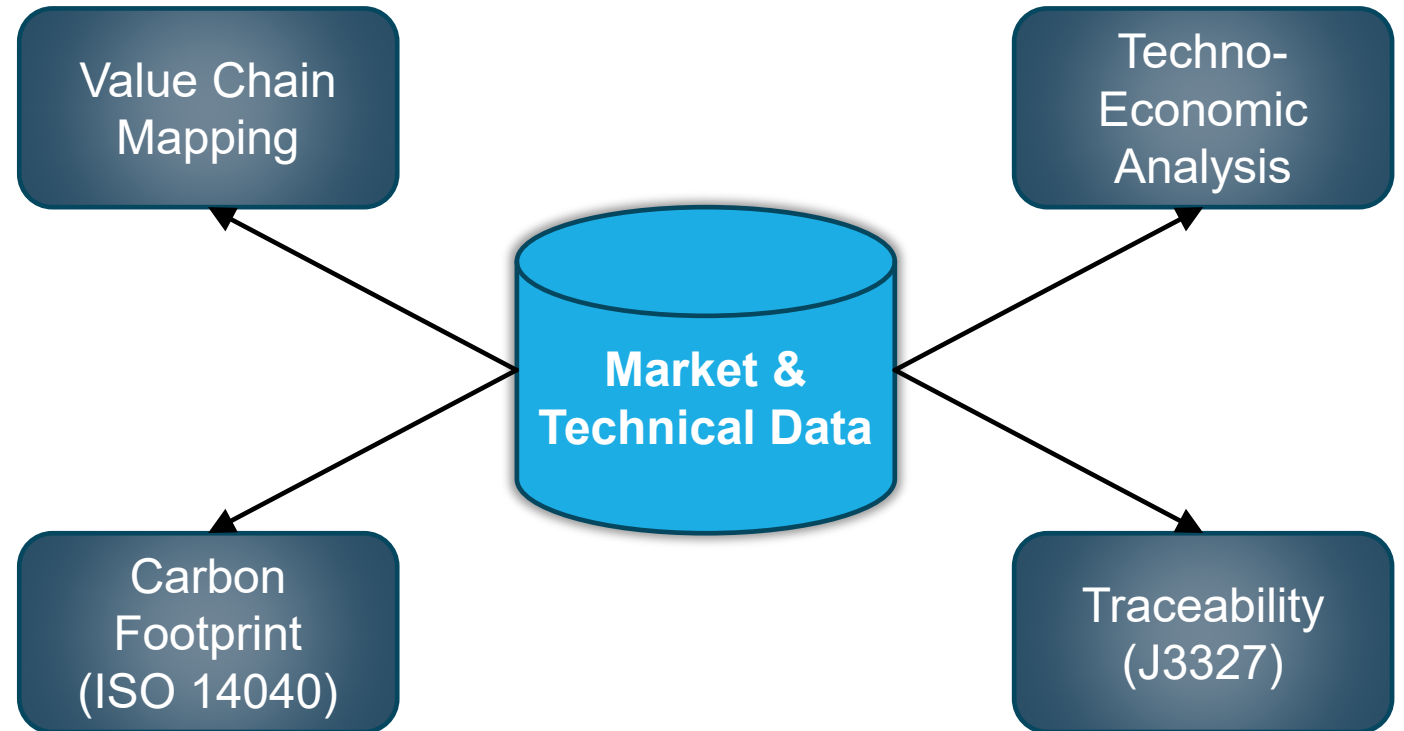



Thank You For Your Time  
Rate! Consulting LLC  
Scan QR Code To Connect

